

	1	2	3	4	5	6	7	8	9	10	11	12	13	14	15	16	17	18	19	20	21	22	23	24	25	26	27	28	29	30	31	32	
a	X	X	X	X	X	X	X	X	X	X	X	X	X	X	X	X	X	X	X	X	X	X	X	X	X	X	X	X	X	X	X	X	X
b																																	
c	X	X	X	X	X	X	X	X	X	X	X	X	X	X	X	X	X	X	X	X	X	X	X	X	X	X	X	X	X	X	X	X	X

NOTES:

- ① Connector Meets Requirement OF DIN 41612
- ② Material:
1.Housing : Glass-Filled PBT. Color: Grey, UL 94V-0
2.Contact : Copper Alloy
- ③ Contact Tail Dimension
Thickness :0.35±0.02mm
Width :0.60±0.04mm
Tail Length :3- 0.4mm
- ④ Contact Finish(Option in Part Number "-x")
-1: 25µ" (0.63µm)Pd/Ni and 2µ"Gold Plating on Mating Area ,100µ"(2.54µm)Tin Plating on Tail Area, Flash Gold Plating on Non-mating Area,50µ" (1.27µm)Nickel Underplate All Over
-2: 12µ" (0.30µm)Pd/Ni and 2µ"Gold Plating on Mating Area ,100µ"(2.54µm)Tin Plating on Tail Area, Flash Gold Plating on Non-mating Area,50µ" (1.27µm)Nickel Underplate All Over
-Blank: Flash Gold Plating on mating Area and non-mating Area, Tin plating in tail Area,Nickel Underplate All Over
- ⑤ Connector Printed with Part Number,and Batch Number
- ⑥ Contact Arrangement
X: Denotes a standard contact
Blank: No contact at that position

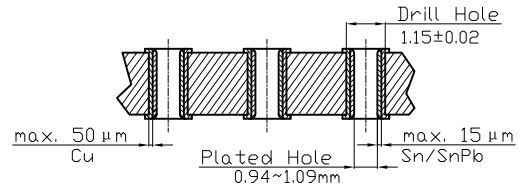

Recommended Hole Specifications
Section A-A
Scale 6:1

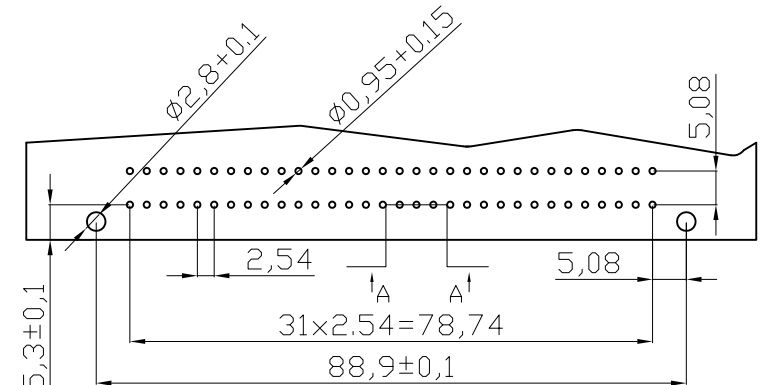
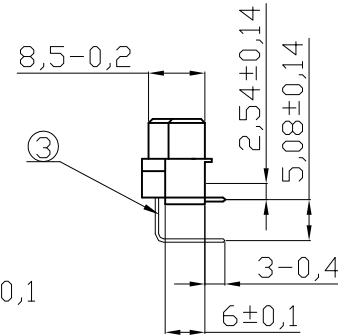
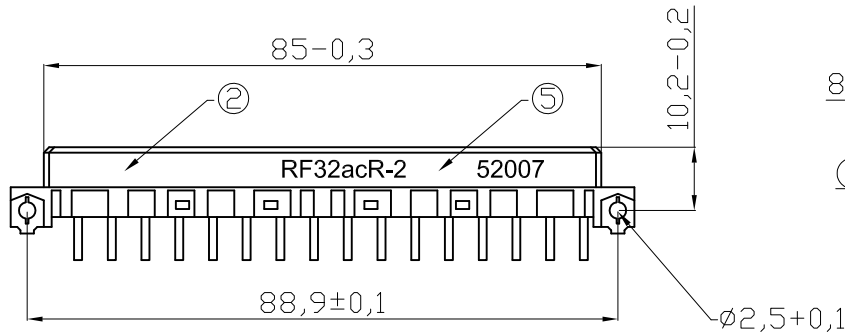
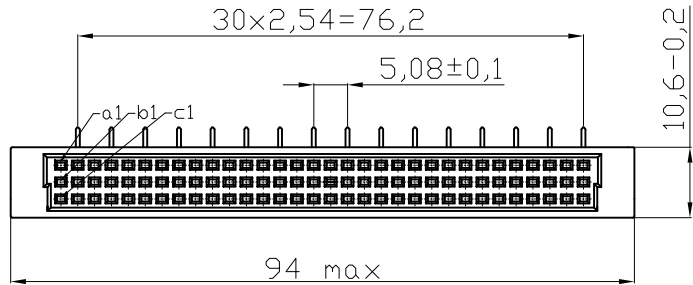

Recommended PCB Hole Layout
Component Side
Scale 1:1

RoHS compliant

Scale	1:1					Date	Name	Customer-No.
TOLERANCE						Drawn	12.01.2010	Dean
X.	±0.25					Approved	07.06.2010	Hellwig
X.X	±0.1							
X.XX	±0.05							
X.XXX	±0.012							
DIM	TOL	②	Modify plating spec.	07.06.2010	Dean			
Angle	±1°	①	Drawn	12.01.2010	Dean			
		Id.	Modification	Date	Name			

Customer-No.		
ASSMANN WSW-No.		A-RF32ACR-x
Drawing-No.		ASS 4027 CO rev02
Replace		Sheet

1

2

3

4

5

6

7